

VITE SVASATA CON ESAGONO 6MA

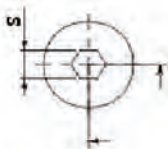

CG 0426 FM

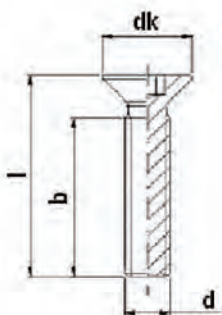

b	d	dk	l	s
5	M6	12	10	4
7	M6	12	12	4
10	M6	12	15	4
11	M6	12	16	4
13	M6	12	18	4
15	M6	12	20	4
20	M6	12	25	4
23	M6	12	28	4
25	M6	12	30	4
30	M6	12	35	4
35	M6	12	40	4
40	M6	12	45	4
45	M6	12	50	4
50	M6	12	55	4
50	M6	12	60	4
55	M6	12	65	4
60	M6	12	70	4
65	M6	12	75	4
65	M6	12	80	4
80	M6	12	90	4
85	M6	12	95	4
95	M6	12	100	4
95	M6	12	110	4
115	M6	12	120	4

MATERIALE / MATERIAL
FERRO/IRON

FINITURA / FINISHING
GREZZO ZINCATO TROPICALE BRUNITO
ROUGH ZINC-PLATED TROPICAL BURNISHED

VITE SVASATA CON ESAGONO 6MA



CG 0426 FM

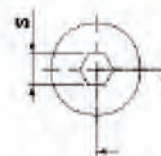
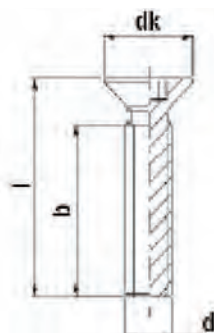

b	d	dk	l	s
9	M8	16	15	5
14	M8	16	20	5
19	M8	16	25	5
22	M8	16	28	5
24	M8	16	30	5
26	M8	16	32	5
29	M8	16	35	5
34	M8	16	40	5
39	M8	16	45	5
44	M8	16	50	5
49	M8	16	55	5
50	M8	16	60	5
55	M8	16	65	5
60	M8	16	70	5
65	M8	16	80	5
75	M8	16	85	5
80	M8	16	90	5
90	M8	16	100	5
95	M8	16	110	5
95	M8	16	120	5

MATERIALE / MATERIAL
FERRO / IRON

FINITURA / FINISHING
GREZZO ZINCATO TROPICALE BRUNITO
ROUGH ZINC-PLATED TROPICAL BURNISHED

VITE SVASATA CON ESAGONO 8MA



CG 0426 FM

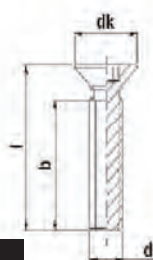

b	d	dk	l	s
9	7/16	16	15	5
14	7/16	16	20	5
19	7/16	16	25	5
22	7/16	16	28	5
24	7/16	16	30	5
26	7/16	16	32	5
29	7/16	16	35	5
34	7/16	16	40	5
39	7/16	16	45	5
44	7/16	16	50	5
49	7/16	16	55	5
50	7/16	16	60	5
55	7/16	16	65	5
60	7/16	16	70	5
65	7/16	16	80	5
75	7/16	16	85	5
80	7/16	16	90	5
90	7/16	16	100	5
95	7/16	16	110	5
95	7/16	16	120	5

MATERIALE / MATERIAL

FERRO/IRON

FINITURA / FINISHING

*GREZZO ZINCATO TROPICALE BRUNITO**ROUGH ZINC-PLATED TROPICAL BURNISHED*

VITE SVASATA CON ESAGONO 10MA

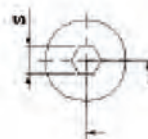
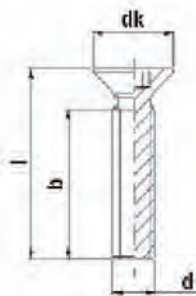

b	d	dk	l	s
17	M10	20	25	6
23	M10	20	30	6
28	M10	20	35	6
33	M10	20	40	6
43	M10	20	50	6
47	M10	20	55	6
50	M10	20	60	6
60	M10	20	70	6
70	M10	20	80	6
80	M10	20	90	6
90	M10	20	100	6

MATERIALE / MATERIAL
FERRO / IRON

FINITURA / FINISHING
GREZZO ZINCATO TROPICALE BRUNITO
ROUGH ZINC-PLATED TROPICAL BURNISHED

VITE SVASATA CON ESAGONO 6MA ZIGRINATA



CG 426E FM

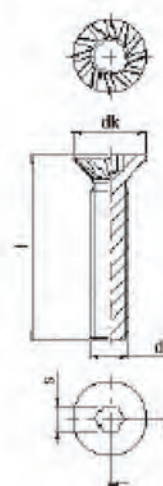

d	dk	l	s
M6	12	30	4
M6	12	50	4

MATERIALE / MATERIAL
FERRO/IRON

FINITURA / FINISHING
GREZZO ZINCATO TROPICALE BRUNITO
ROUGH ZINC-PLATED TROPICAL BURNISHED

VITE A BRUGOLA NON TEMPERATA



CG0514FM



b	d	dk	k	l	s
11	M6	15	3,5	15	5
16	M6	15	3,5	20	5
21	M6	15	3,5	25	5
26	M6	15	3,5	30	5
31	M6	15	3,5	35	5
36	M6	15	3,5	40	5
41	M6	15	3,5	45	5
46	M6	15	3,5	50	5
47	M6	15	3,5	51	5
50	M6	15	3,5	55	5
50	M6	15	3,5	60	5
50	M6	15	3,5	63	5
55	M6	15	3,5	65	5
60	M6	15	3,5	70	5
65	M6	15	3,5	75	5
65	M6	15	3,5	76	5
65	M6	15	3,5	80	5
80	M6	15	3,5	90	5
90	M6	15	3,5	100	5

MATERIALE / MATERIAL

FERRO / IRON

FINITURA / FINISHING

ZINCATO BRUNITO

ZINC-PLATED BURNISHED

VITE A BRUGOLA NON TEMPERATA



CG 0425 FM

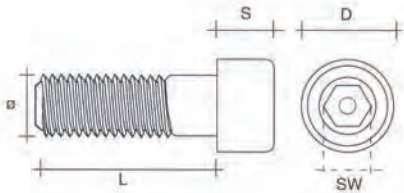

Ø	L							D	S	SW
6 MA	15	20	25	30	35	40	45	10	6	5
	50	60	80	70						
8 MA	25	30	35	40	45	50	60	13	8	8
	70	80	85	90	100	110				

FINITURA / FINISHING
GREZZO TROPICALE BRUNITO
ROUGH TROPICAL BURNISHED

RANELLA SEDE

MATERIALE / MATERIAL
FERRO / IRON



Misura (A)	Misura (B)	Finitura
Size (A)	Size (B)	Finishing
12	7	Nero/Black
15	9	Nero/Black

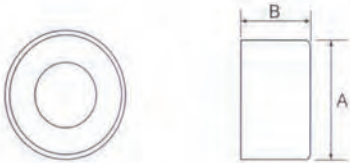

VITE PER POMOLI 4MA



CG 0404 FM

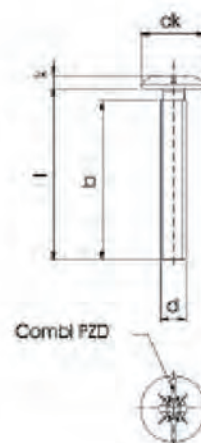

b	Combi PZD	d	dk	k	l
5	2	M4	10	2	7
6	2	M4	10	2	8
14	2	M4	10	2	16
21	2	M4	10	2	23
24	2	M4	10	2	26
29	2	M4	10	2	31
34	2	M4	10	2	36
50	2	M4	10	2	53
50	2	M4	10	2	55
50	2	M4	10	2	60
7,5	2	M4	10	2	9,5
8,5	2	M4	10	2	10,5
10,5	2	M4	10	2	12,5
11,5	2	M4	10	2	13,5
12,5	2	M4	10	2	14,5
13,5	2	M4	10	2	15,5
15,5	2	M4	10	2	17,5
17,5	2	M4	10	2	19,5
18,5	2	M4	10	2	20,5
19,5	2	M4	10	2	21,5
20,5	2	M4	10	2	22,5
21,5	2	M4	10	2	23,5
22,5	2	M4	10	2	24,5
25,5	2	M4	10	2	27,5
27,5	2	M4	10	2	29,5
29,5	2	M4	10	2	31,5
30,5	2	M4	10	2	32,5
32,5	2	M4	10	2	34,5
35,5	2	M4	10	2	37,5
37,5	2	M4	10	2	39,5
39,5	2	M4	10	2	41,5
40,5	2	M4	10	2	42,5
42,5	2	M4	10	2	44,5
45,5	2	M4	10	2	47,5
47,5	2	M4	10	2	49,5
50	2	M4	10	2	51,5
50	2	M4	10	2	54,5
50	2	M4	10	2	55,5

MATERIALE / MATERIAL
FERRO / IRON

FINITURA / FINISHING
ZINCATO TROPICALE BRUNITO BRONZATO
ZINC-PLATED TROPICAL BURNISHED BRONZED

VITE TBL COMBI 6MA



CG 0413 FM

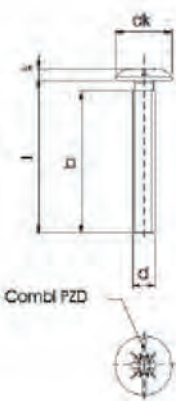

b	Combi PZD	d	dk	k	l
8	3	M6	15	3,5	10
10	3	M6	15	3,5	12
11	3	M6	15	3,5	13
14	3	M6	15	3,5	16
23	3	M6	15	3,5	25
28	3	M6	15	3,5	30
33	3	M6	15	3,5	35
38	3	M6	15	3,5	40
43	3	M6	15	3,5	45
48	3	M6	15	3,5	50
50	3	M6	15	3,5	55
50	3	M6	15	3,5	60
55	3	M6	15	3,5	65
60	3	M6	15	3,5	70
65	3	M6	15	3,5	75
65	3	M6	15	3,5	80
75	3	M6	15	3,5	85
80	3	M6	15	3,5	90

MATERIALE / MATERIAL
FERRO / IRON

FINITURA / FINISHING
ZINCATO TROPICALE BRUNITO BRONZATO
ZINC-PLATED TROPICAL BURNISHED BRONZED

VITE TBL COMBI 7/16



CG 0413 FM

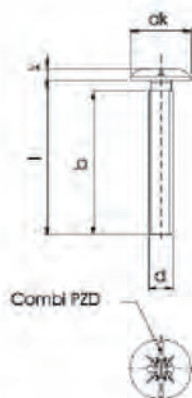

b	Combi PZD	d	dk	k	l
13	3	7/16	15	3,5	15
18	3	7/16	15	3,5	20
23	3	7/16	15	3,5	25
28	3	7/16	15	3,5	30
33	3	7/16	15	3,5	35
38	3	7/16	15	3,5	40
43	3	7/16	15	3,5	45
48	3	7/16	15	3,5	50
50	3	7/16	15	3,5	55
50	3	7/16	15	3,5	60
60	3	7/16	15	3,5	70
65	3	7/16	15	3,5	80
75	3	7/16	15	3,5	85
80	3	7/16	15	3,5	90
90	3	7/16	15	3,5	100

MATERIALE / MATERIAL

FERRO / IRON

FINITURA / FINISHING

*ZINCATO TROPICALE BRUNITO BRONZATO**ZINC-PLATED TROPICAL BURNISHED BRONZED*

VITE TBL COMBI 8MA



CG 0413 FM

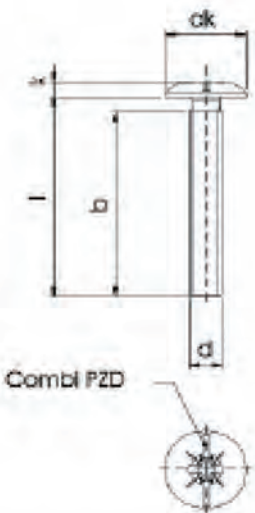

b	Combi PZD	d	dk	k	l
13	3	M8	16	4	15
18	3	M8	16	4	20
23	3	M8	16	4	25
28	3	M8	16	4	30
33	3	M8	16	4	35
38	3	M8	16	4	40
43	3	M8	16	4	45
48	3	M8	16	4	50
50	3	M8	16	4	55
50	3	M8	16	4	60
60	3	M8	16	4	70
65	3	M8	16	4	80
80	3	M8	16	4	90

MATERIALE / MATERIAL
FERRO / IRON

FINITURA / FINISHING
ZINCATO TROPICALE BRUNITO BRONZATO
ZINC-PLATED TROPICAL BURNISHED BRONZED

VITE BOMBATA CON QUADRO 6MA



CG 0407 FM

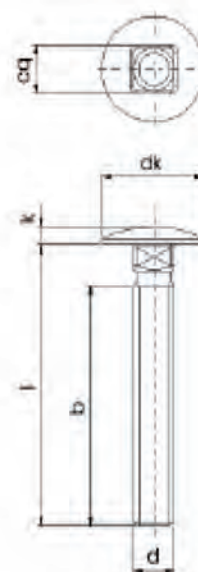

b	cq	d	dk	k	l
10	6	M6	15	2,5	16
14	6	M6	15	2,5	20
19	6	M6	15	2,5	25
21	6	M6	15	2,5	27
24	6	M6	15	2,5	30
26	6	M6	15	2,5	32
29	6	M6	15	2,5	35
34	6	M6	15	2,5	40
39	6	M6	15	2,5	45
44	6	M6	15	2,5	50
50	6	M6	15	2,5	55
50	6	M6	15	2,5	60
55	6	M6	15	2,5	65
60	6	M6	15	2,5	70
65	6	M6	15	2,5	75
65	6	M6	15	2,5	80
80	6	M6	15	2,5	90
95	6	M6	15	2,5	100
95	6	M6	15	2,5	110
95	6	M6	15	2,5	120

MATERIALE / MATERIAL
FERRO/IRON

FINITURA / FINISHING
ZINCATO TROPICALE BRUNITO BRONZATO
ZINC-PLATED TROPICAL BURNISHED BRONZED

VITE BOMBATA CON QUADRO 8MA



CG 0407 FM

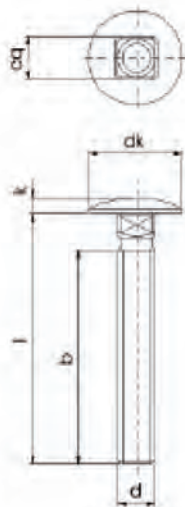

b	cq	d'	dk	k	l
10	8	M8	18,5	3,95	16
14	8	M8	18,5	3,95	20
16	8	M8	18,5	3,95	22
19	8	M8	18,5	3,95	25
24	8	M8	18,5	3,95	30
29	8	M8	18,5	3,95	35
34	8	M8	18,5	3,95	40
39	8	M8	18,5	3,95	45
44	8	M8	18,5	3,95	50
49	8	M8	18,5	3,95	55
50	8	M8	18,5	3,95	60
55	8	M8	18,5	3,95	65
60	8	M8	18,5	3,95	70
65	8	M8	18,5	3,95	75
65	8	M8	18,5	3,95	80
80	8	M8	18,5	3,95	90
95	8	M8	18,5	3,95	100
95	8	M8	18,5	3,95	110
95	8	M8	18,5	3,95	120
95	8	M8	18,5	3,95	130
95	8	M8	18,5	3,95	140

MATERIALE / MATERIAL
FERRO / IRON

FINITURA / FINISHING
ZINCATO TROPICALE BRUNITO BRONZATO
ZINC-PLATED TROPICAL BURNISHED BRONZED



CG 0400 FM

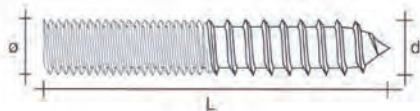

MATERIALE / MATERIAL
FERRO/IRON

FINITURA / FINISHING
GREZZA
ROUGH

Ø	L											d
6 MA	25	30	40	50	60	70	80	90				6,3
8 MA	33	40	50	60	70	80	90	100	120			8,5
7/16"	33	40	50	60	70	80	90	100	110	120		9
10 MA	33	40	50	60	70	80	90	100	120	130		10,7
	150	160	170	180	200	220	230	250	300			

VITE RULLATA 4MA



CG 0400 FM



b	d	Ø	l
5	M4	3.2	20
20	M4	3.2	50

MATERIALE / MATERIAL
FERRO / IRON

FINITURA / FINISHING
GREZZA ZINCATA
ROUGH ZINC-PLATED

TRONCHETTO FILETTATO 6MA



CG 0401 FM



d	l
M6	16
M6	18
M6	20
M6	22
M6	24
M6	26
M6	28
M6	30
M6	32
M6	36
M6	38
M6	40
M6	42
M6	44
M6	46
M6	48
M6	50
M6	55
M6	57
M6	60
M6	63
M6	65
M6	70
M6	76
M6	80
M6	82
M6	85
M6	90
M6	95
M6	97
M6	100
M6	102
M6	105
M6	108
M6	110
M6	115
M6	120
M6	125
M6	130
M6	135

MATERIALE / MATERIAL

FERRO / IRON

FINITURA / FINISHING

GREZZO

ROUGH

TRONCHETTO FILETTATO 8MA



CG 0401 FM



d	l
M8	25
M8	30
M8	32
M8	36
M8	38
M8	40
M8	45
M8	48
M8	50
M8	55
M8	57
M8	60
M8	63
M8	65
M8	70
M8	76
M8	80
M8	90
M8	95
M8	100
M8	110
M8	115
M8	120
M8	130

MATERIALE / MATERIAL
FERRO/IRON

FINITURA / FINISHING
GREZZO
ROUGH



CG 0515 FM

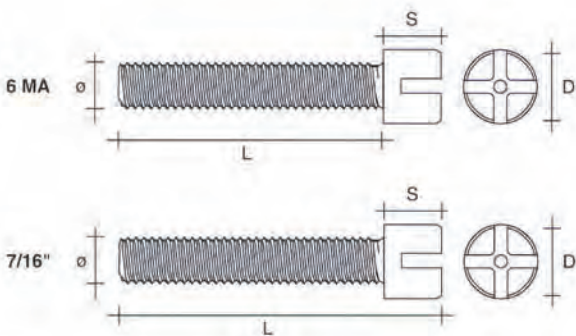

Ø	L												S	D
6 MA	30	35	40	45	50	60	70	80					7,5	10
7/16"	35	40	50	60	65	70	80	90	100	110	120		9,5	11,5

MATERIALE / MATERIAL
FERRO / IRON

FINITURA / FINISHING
GREZZA ZINCATA
ROUGH ZINC-PLATED

CALOTTA IN NYLON RINFORZATA



CG 0305 FM

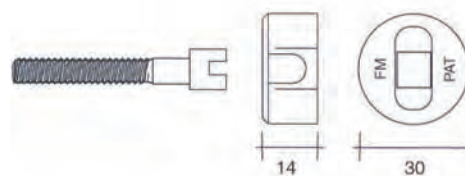

COLORI/COLOURS
NOCE AVORIO / WALNUT IVORY

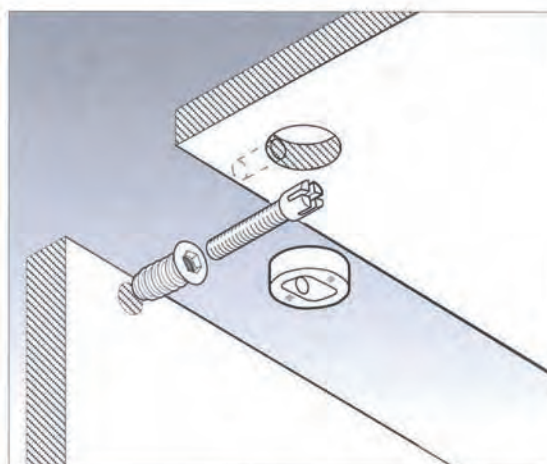

VITE PER GAMBE TAVOLO 8MA



CG 0406 FM

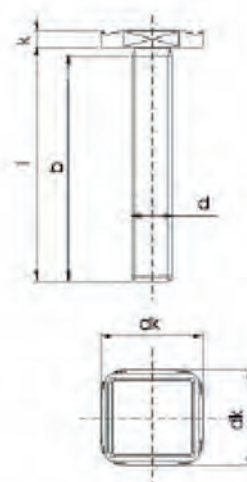

b	d	dk	k	l
38	M8	20,5	3,5	40
48	M8	20,5	3,5	50
58	M8	20,5	3,5	60
50	M8	20,5	3,5	65
50	M8	20,5	3,5	70
50	M8	20,5	3,5	80
65	M8	20,5	3,5	90
65	M8	20,5	3,5	100
65	M8	20,5	3,5	110

MATERIALE / MATERIAL
FERRO / IRON

FINITURA / FINISHING
GREZZO ZINCATO
ROUGH ZINC-PLATED

VITI PER ARMADIO TE



CG 0412 FM

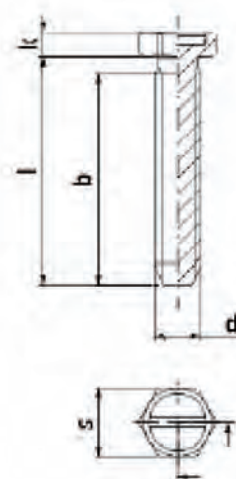

b	d	k	l	s
23	7/16	4,5	25	12
28	7/16	4,5	30	12
33	7/16	4,5	35	12
38	7/16	4,5	40	12
43	7/16	4,5	45	12
45	7/16	4,5	50	12
45	7/16	4,5	55	12
50	7/16	4,5	60	12
50	7/16	4,5	65	12
60	7/16	4,5	75	12

MATERIALE / MATERIAL
FERRO / IRON

FINITURA / FINISHING
GREZZO
ROUGH

AUTOFILETTANTI PER CONGLOMERATO / Chipboard Screws

CG 0427 FM

FINITURA

nero, zincato
bronzato
tropicale

Ø	L															
2,6	10	12	15	18	20	25	30									
3	10	12	15	18	20	25	30	35	40	45						
3,5	10	12	15	18	20	25	30	35	40	45	50					
4		12	15	18	20	25	30	35	40	45	50	60	70			
4,5			15	18	20	25	30	35	40	45	50	60	70			
5				20	25	30	35	40	45	50	60	70	80			

TP



TC

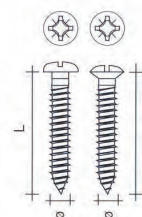

TGS



AUTOFILETTANTE CON FLANGIA / Self Tapping Screw

CG 0427 FM

FINITURA

nero, zincato
bronzato
tropicale

Combi PZD	Ø	dk	k	l
2	4	10	2,3	12
2	4	10	2,3	14
2	4	10	2,3	15
2	4	10	2,3	16
2	4	10	2,3	17
2	4	10	2,3	18
2	4	10	2,3	20
2	4	10	2,3	25
2	4	10	2,3	30
2	4	10	2,3	35
2	4	10	2,3	40
2	4	10	2,3	45
2	4	10	2,3	50

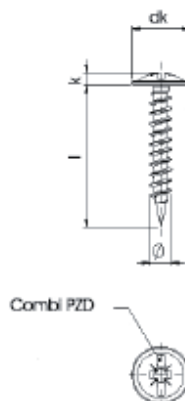

VITE MONTAGGIO CON GAMBO mm 7 COMBINATA CROCE + ESAGONO

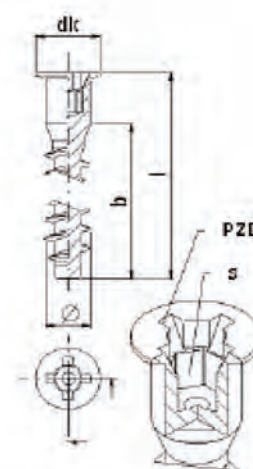
CG 433A FM

b	Ø	dk	l	PZD	s
21,5	7	10	30	3	4
31,5	7	10	40	3	4
41,5	7	10	50	3	4
48	7	10	60	3	4
58	7	10	70	3	4

MATERIALE / MATERIAL

FERRO / IRON

FINITURA / FINISHING

NERO ZINCATO TROPICALE
BLACK ZINC-PLATED TROPICAL

VITE MONTAGGIO PZD



CG 416A FM



b	Ø	dk	l	PZD
21,5	7	10	30	3
26,5	7	10	35	3
31,5	7	10	40	3
36,5	7	10	45	3
41,5	7	10	50	3
43	7	10	55	3
48	7	10	60	3
58	7	10	70	3

MATERIALE / MATERIAL
FERRO / IRON

FINITURA / FINISHING
GREZZO
ROUGH

VITE MONTAGGIO TPSE



CG 416A FM



b	Ø	dk	l	s
21,5	7	10	30	4
26,5	7	10	35	4
29,5	7	10	38	4
31,5	7	10	40	4
36,5	7	10	45	4
41,5	7	10	50	4
43	7	10	55	4
48	7	10	60	4
58	7	10	70	4

MATERIALE / MATERIAL
FERRO / IRON

FINITURA / FINISHING
GREZZO
ROUGH

TAPPO PER VITI MONTAGGIO NYLON



CG 060033 CF

FINITURA / FINISHING
NERO BIANCO MARRONE
BLACK WHITE BROWN

MISURA / SIZE
Ø 12 / Ø 12

EUROVITI PIANE O CILINDRICHE POZI DRIVE

CG 422G FM - CG 422P FM

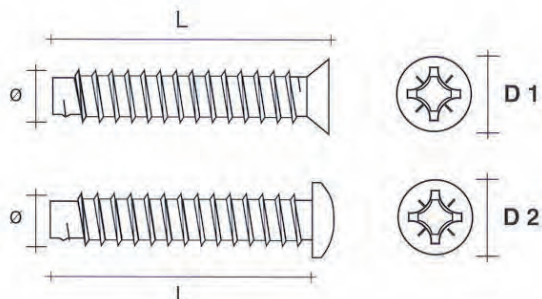

Ø	L				D1	
6,30	9	10	11	13	7,2	8

Ø	L				D2
6,30	9	10	11	13	8

ura: NERO ZINCATO NICHELATO

Euroviti / Euroscrews

Art.	Ø	l	b	
CGEV0107CR	7	9	f.l.6	10000
CGEV0207CR	7	11	f.l.6	10000
CGEV0307CR	7	13	f.l.6	10000
CGEV0407CR	7	15	f.l.6	5000
CGEV0507CR	7	11	m6	10000
CGEV0607CR	7	13	m6	10000
CGEV0707CR	7	15	m6	5000
CGEV0807CR	7	12	m4	10000
CGEV0907CR	7	14	m4	5000

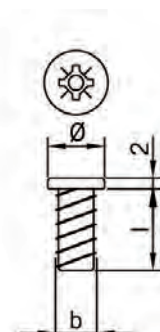

Euroviti / Euroscrews

Art.	Ø	l	b	
CGEV1007CR	7	10	f.l.6	10000
CGEV1107CR	7	11	f.l.6	10000
CGEV1207CR	7	12	f.l.6	10000
CGEV1307CR	7	13	f.l.6	5000
CGEV1407CR	7	15	f.l.6	10000
CGEV1507CR	7	17	f.l.6	10000

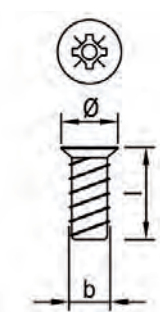

Euroviti / Euroscrews

Art.	Ø	l	b	
CGEV1607CR	7	10	f.l.6,3	10000
CGEV1707CR	7	11	f.l.6,3	10000
CGEV1807CR	7	12	f.l.6,3	10000
CGEV1907CR	7	13	f.l.6,3	10000
CGEV2007CR	7	15	f.l.6,3	10000
CGEV2107CR	7	17	f.l.6,3	10000



VITA GIUNZIONE PER FORI 8 mm

CG 0555 FM

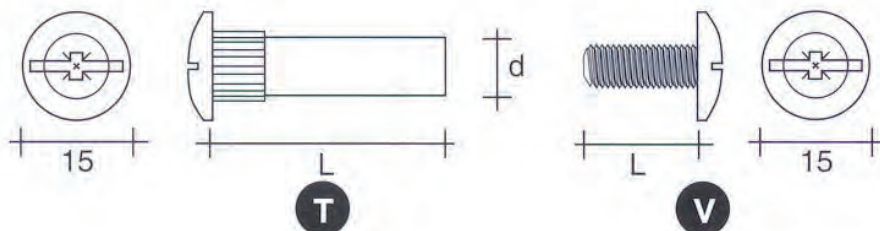

V	L
6 MA	14 20

T	L	d
6 MA	15 25 31 38	8

Finitura: NERA ZINCATA NICHELATA OTTONATA BRONZATA



VITA GIUNZIONE PER FORI 5 mm

CG 0565 FM

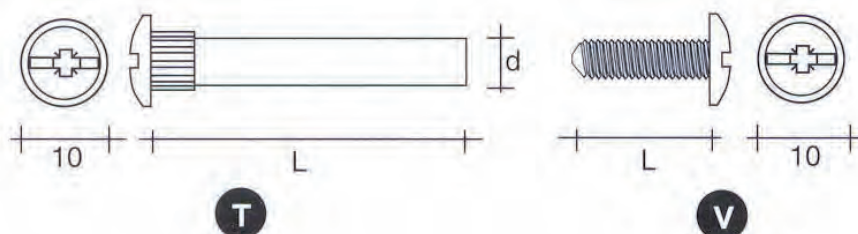

V	L
4 MA	14 20

T	L	d
4 MA	15 20 25 27 30 35	5

Finitura: NERA ZINCATA NICHELATA OTTONATA BRONZATA



VITA GIUNZIONE ZIGRINATA PER FORI 5 mm

CG 5651 FM

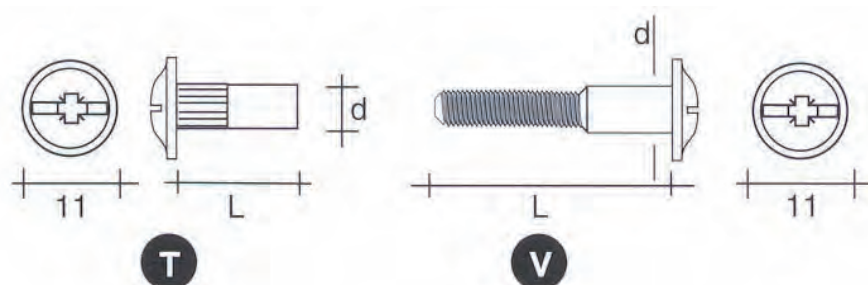

T	L	d
4 MA	15	5

V	L	d
4 MA	27	5

Finitura: NERA ZINCATA NICHELATA OTTONATA BRONZATA



VITA GIUNZIONE ZIGRINATA PER FORI 8 mm

CG 0516 FM

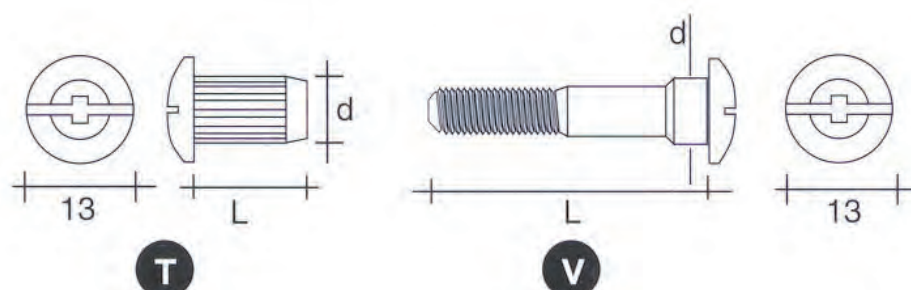

T	L	d
6 MA	14	8

V	L			d
6 MA	23	30	32	8

Finitura: NERA ZINCATA NICHELATA OTTONATA BRONZATA



VITA GIUNZIONE PER FORI 5 mm

Art.	l	b	
CGVG2807CR	10	m4	10000
CGVG2907CR	12	m4	10000
CGVG3007CR	14	m4	10000
CGVG3107CR	15	m4	10000
CGVG3207CR	18	m4	10000
CGVG3307CR	22	m4	10000
CGVG3407CR	25	m4	10000
CGVG3507CR	30	m4	10000

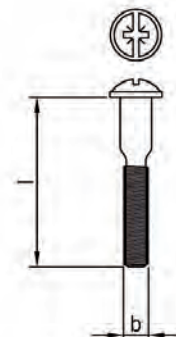

VITA GIUNZIONE PER FORI 5 mm

Art.	l	b	
CGVG2707CR	29	m4	10000

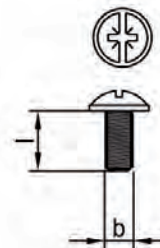

GIUNZIONI PER PIANI DI LAVORO

CG 0665 FM

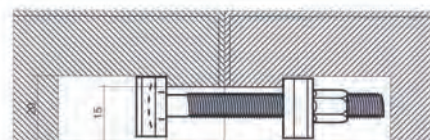
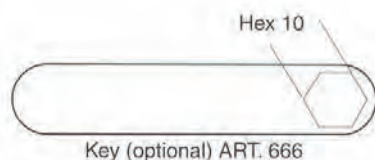
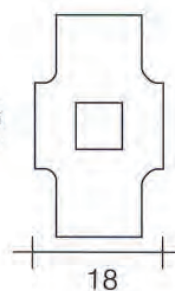
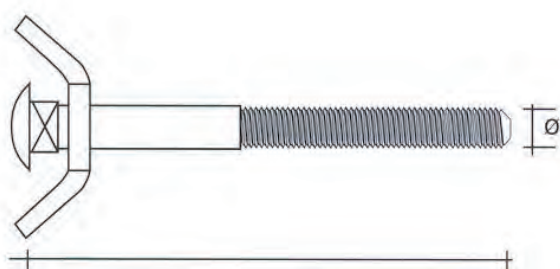

Ø	L
6 MA	65 100 120 150

Finitura: GREZZO ZINCATO

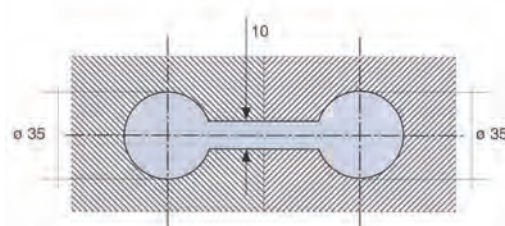

VITE UNIONE 6MA

CG 0516 FM

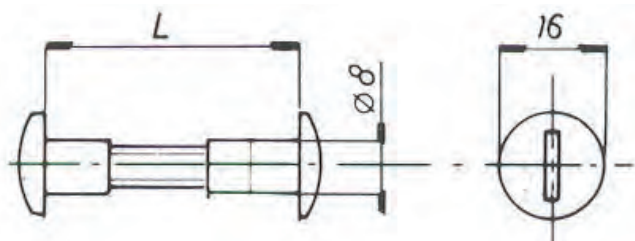

MATERIALE TESTA / HEAD MATERIAL
NYLON / NYLON

MATERIALE GAMBO / STEM MATERIAL
ACCIAIO / STEEL

FINITURA TESTA / HEAD FINISHING
BIANCO NERO MARRONE
WHITE BLACK BROWN

Misure: mm. 26/36 - mm. 30/40 - mm. 34/44 - mm. 42/52 - mm. 48/58

BULLONE TUTTO FILETTO SENZA DADO THREAD BOLTS WITHOUT NUT

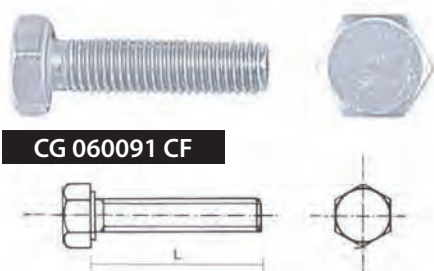

CG 060091 CF

FINITURA / FINISHING
GREZZA ZINCATA
ROUGH ZINC-PLATED

MATERIALE / MATERIAL
FERRO / IRON

LUNGHEZZA mm	MISURE FILETTO				
	M4	M5	M6	M8	M10
16	●	●	●	●	●
20	●	●	●	●	●
25	●	●	●	●	●
30	●	●	●	●	●
35	●	●	●	●	●
40	●	●	●	●	●
45	●	●	●	●	●
50	●	●	●	●	●
55		●	●	●	●
60		●	●	●	●
70			●	●	●
80			●	●	●
90				●	●
100				●	●
110					●
120					●

VITE TC TC SCREW



CG 060100 CF

FINITURA / FINISHING
GREZZA ZINCATA
ROUGH ZINC-PLATED

MATERIALE / MATERIAL
FERRO / IRON

LUNGHEZZA mm	MISURE FILETTO		
	M4	M5	M6
8	●		
10	●	●	●
12	●	●	●
16	●	●	●
20	●	●	●
25	●	●	●
30	●	●	●
35	●	●	●
40	●	●	●
50			●

VITE TP TP SCREW



CG 060102 CF

FINITURA / FINISHING
GREZZA ZINCATA
ROUGH ZINC-PLATED

MATERIALE / MATERIAL
FERRO / IRON

LUNGHEZZA mm	MISURE FILETTO		
	M4	M5	M6
8	●	●	●
10	●	●	●
12	●	●	●
16	●	●	●
20	●	●	●
25	●	●	●
30	●	●	●
35	●	●	●
40	●	●	●
50			●
60			●