

SERRATURA CON CILINDRO / Cylinder with lock

CG 01S ACA

FUNZIONAMENTO

rotazione 360°
(2 uscite chiavi)

APPLICAZIONE

antina dx-sx

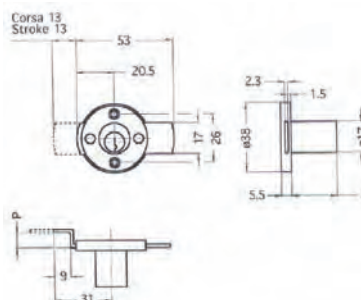

SERRATURA CON CILINDRO / Cylinder with lock

CG 01S CCA

FUNZIONAMENTO

rotazione 360°
(2 uscite chiavi)

APPLICAZIONE

cassetto

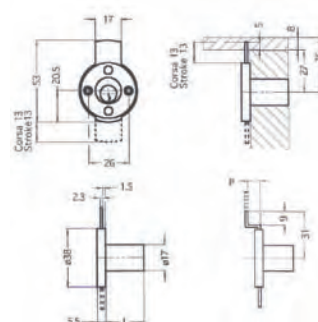

SERRATURA CASSA E CILINDRO IN NYLON / Nylon cylinder and case lock

CG 03S ACA

FUNZIONAMENTO

rotazione 360°
(2 uscite chiavi)

APPLICAZIONE

antina dx-sx

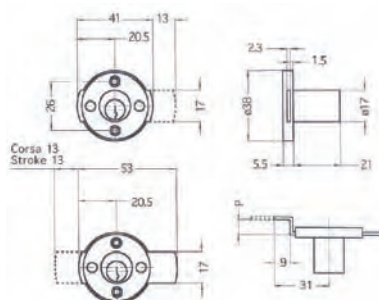

SERRATURA CASSA E CILINDRO IN NYLON / Nylon cylinder and case lock

CG 03S CCA

FUNZIONAMENTO

rotazione 360°
(2 uscite chiavi)

APPLICAZIONE

cassetto

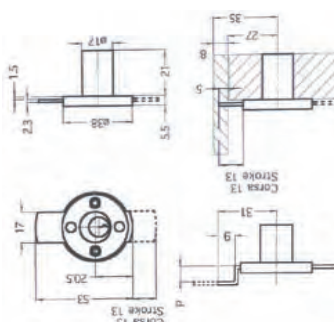

SERRATURA A CILINDRO / Cylinder lock

CG 0320 CA

APPLICAZIONE

ante

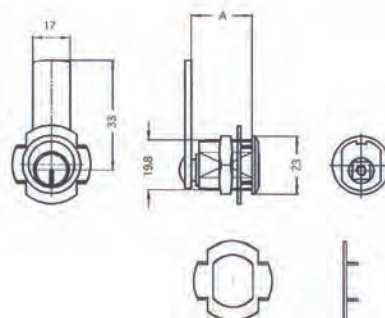

SERRATURA PER ANTA SCORREVOLE / Lock for sliding door

CG 0176 CA

FUNZIONAMENTO

rotazione 30°
(2 uscite chiave)

APPLICAZIONE

anta scorrevole
chiusura a pulsante

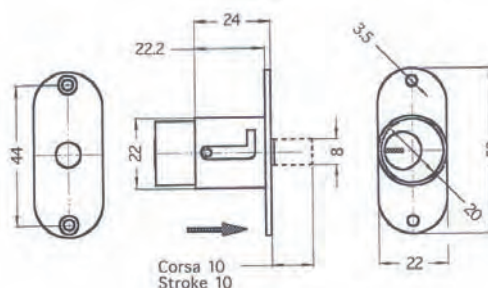

SERRATURE PER CASSETTIERE / Locks for chests of drawers

CG 0175 CA

FUNZIONAMENTO

rotazione 360°
(2 uscite chiavi)
a richiesta 180°
(1 uscita chiave)

APPLICAZIONE

cassettiere
(chiusure multiple)
montaggio frontale

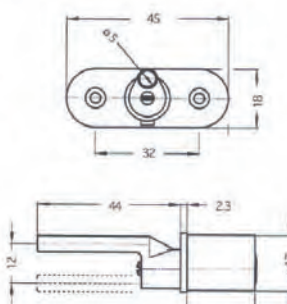

SERRATURA PER ANTA SCORREVOLE CHIUSURA A SPINTA / Locks for sliding door push lockingcase lock

CG 0178 CA

FUNZIONAMENTO

rotazione 90°
(2 uscite chiave)

APPLICAZIONE

ante scorrevoli
chiusura a spinta

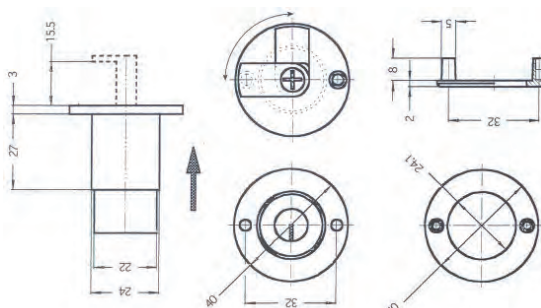

SERRATURA PER CASSETTIERA / Lock for chests of drawer

CG 0025 CA

FUNZIONAMENTO

APPLICAZIONE

rotazione 360 °
(2 uscite chiavi)

cassettiere
(chiusure multiple)
montaggio laterale

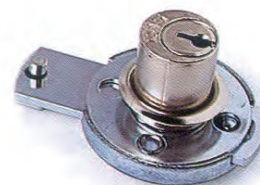
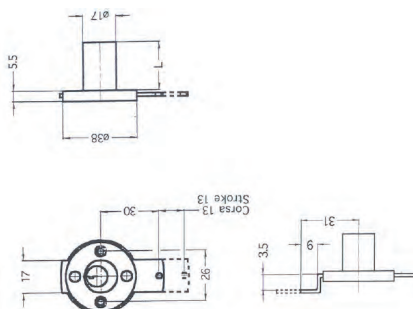

SERRATURA PER CASSETTIERA IN NYLON / Lock for chests of drawers in nylon

CG 005S CA

FUNZIONAMENTO

APPLICAZIONE

rotazione 360 °
(2 uscite chiavi)

cassettiere
(chiusure multiple)
montaggio laterale

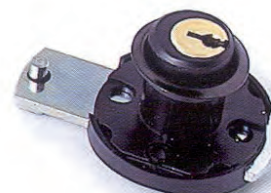
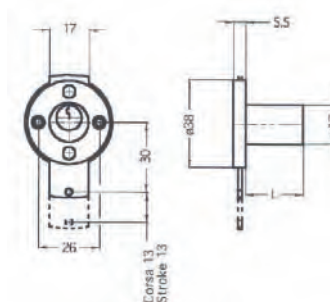

PERNO REGOLABILE / Adjustable pin

CG 0328 CA

MATERIALE

zama

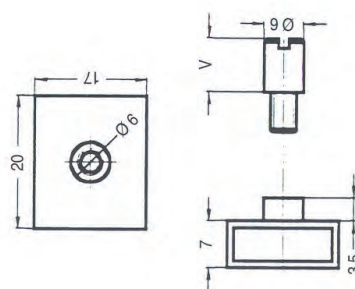

CAVALLOTTO PER ASTA PIATTA / Saddle for flat bar

CG 0412 CA

MATERIALE

ferro

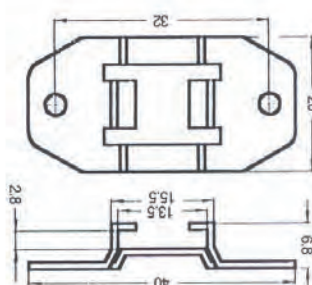

ASTA PIATTA / Flat bar

CG 0581 CA

FINITURA

zincata

*disponibile anche con perni regolabili

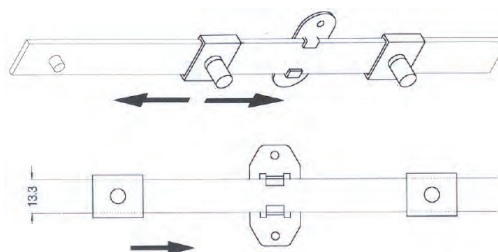

SERRATURA PER QUADRI ELETTRICI CHIAVE SPECIALE / Lock for electric boards special key

CG 0541 CA

FUNZIONAMENTO

rotazione 90 °

APPLICAZIONE

quadri elettrici
(chiave speciale
vedi disegno)

FINITURA

zama nichelata

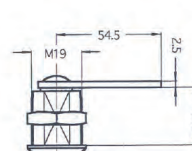
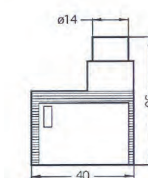
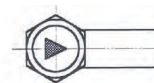
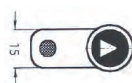

BOCCHETTA PER CILINDRO DA CL 17 / Cylinder for plate CL 17

CG 0401 CA

FINITURA

ottonata nickelata
nero bronzato



CHIAVI PER CILINDRO / Cylinder for keys

Art.	DESCRIZIONE
CG 08201 CA	Chiave 3 spine cifrata nickelata
CG 08202 CA	Chiave 3 spine cifrata nickelata neutra
CG 0823 CA	Chiave 3 spine non cifrata nickelata
CG 0824 CA	Chiave 3 spine non cifrata nickelata neutra
CG 0825 CA	Chiave 4 spine cifrata nickelata
CG 0826 CA	Chiave 4 spine cifrata nickelata neutra
CG 0827 CA	Chiave 4 spine non cifrata nickelata
CG 0828 CA	Chiave 4 spine non cifrata nickelata neutra



CHIAVI CON COPRICHIAVE IN PLASTICA / Nylon key cover with keys

Art.	DESCRIZIONE
CG 82P1 CA	Chiave 3 spine cifrata bianca
CG 82P2 CA	Chiave 3 spine cifrata nera
CG 82P3 CA	Chiave 3 spine non cifrata bianca
CG 82P4 CA	Chiave 3 spine non cifrata nera
CG 82P5 CA	Chiave 4 spine cifrata bianca
CG 82P6 CA	Chiave 4 spine cifrata nera
CG 82P7 CA	Chiave 4 spine non cifrata bianca
CG 82P8 CA	Chiave 4 spine non cifrata nera



CHIAVE RECUPERATA / Trimmed key

Art.	DESCRIZIONE
CG 82R1 CA	Chiave Chiave recuperata ottone 3 spine nickelata cifrata
CG 82R2 CA	Chiave Chiave recuperata ottone 3 spine nickelata non cifrata
CG 82R3 CA	Chiave Chiave recuperata ottone 4 spine nickelata cifrata
CG 82R4 CA	Chiave Chiave recuperata ottone 4 spine nickelata non cifrata



SERRATURA AD ASTE ROTANTI CON CODULI / *Sleeves with espagnolette lock*

CG 222N CA
FUNZIONAMENTO

 rotazione 360°
(2 uscita chiave)

APPLICAZIONE

 ante destre e
sinistre

A richiesta catenaccio a filo

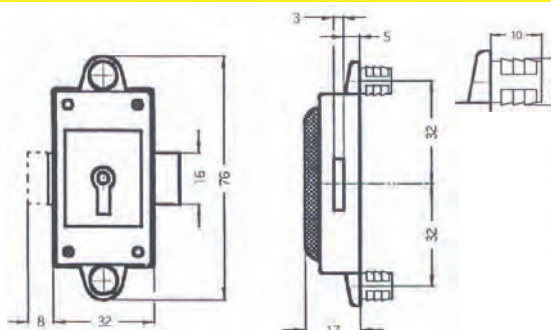

SERRATURA AD ASTE ROTANTI AVVITARE / *Screwed espagnolette lock*

CG 223N CA
FUNZIONAMENTO

 rotazione 360°
(2 uscita chiave)

APPLICAZIONE

 ante destre e
sinistre

A richiesta catenaccio a filo

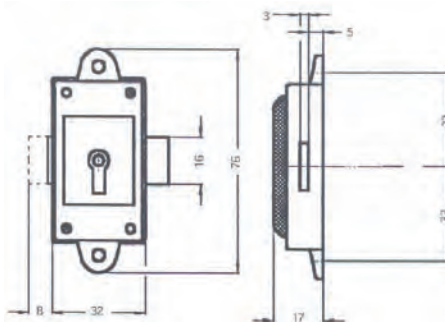

SERRATURA ASTE ROTANTI CON CILINDRO E CODULI / *Sleeves and cylinder with espagnolette lock*

CG 222C CA
FUNZIONAMENTO

 rotazione 360°
(2 uscita chiave)

APPLICAZIONE

 ante destre e
sinistre

A richiesta catenaccio a filo

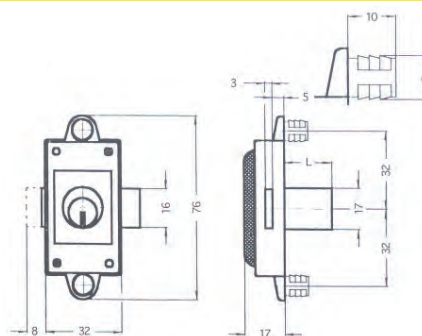

SERRATURA ASTE ROTANTI CON CILINDRO AVVITARE / *Screwed cylinder with espagnolette lock*

CG 223C CA
FUNZIONAMENTO

 rotazione 360°
(2 uscita chiave)

APPLICAZIONE

 ante destre e
sinistre

A richiesta catenaccio a filo

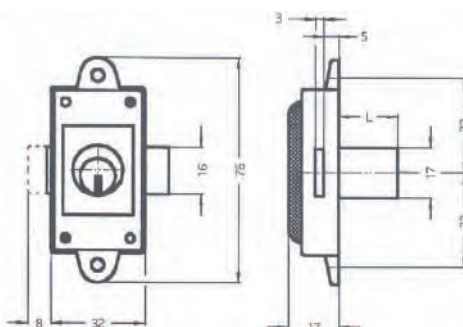

SERRATURA TUTTA METALLO DA AVVITARE CON CHIAVE NORMALE

Lock to be screwed with standard key entirely mode of metal

CG 215N CA

MISURA CATENACCIO	MISURA ENTRATA
mm. 38-48-55	mm. 15-25-33
DISPONIBILE	FINITURA
rotazione 360°	bronzata-nichelata ottonata-verniciata nera

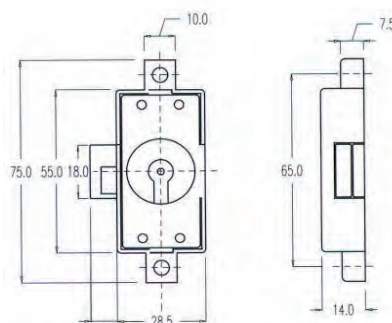

SERRATURA TUTTA METALLO CON CODOLI CHIAVE NORMALE

Lock with sleeves en standard key entirely mode of metal

CG 214N CA

MISURA CATENACCIO	MISURA ENTRATA
mm. 38-48-55	mm. 15-25-33
DISPONIBILE	FINITURA
rotazione 360°	bronzata-nichelata ottonata-verniciata nera

A richiesta catenaccio a filo

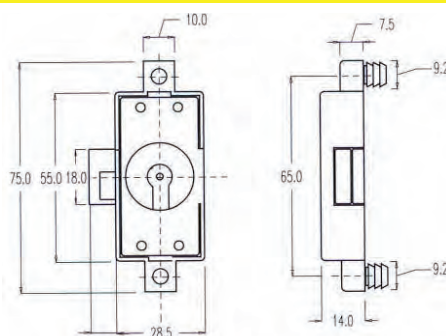

SERRATURA TUTTA METALLO DA AVVITARE CON CILINDRO

Lock to be screwed with cylinder key entirely mode of metal

CG 215C CA

MISURA CATENACCIO	MISURA ENTRATA
mm. 38-48-55	mm. 15-25-33
DISPONIBILE	FINITURA
rotazione 360° rotazione 90°	bronzata-nichelata ottonata-verniciata nera
FINIT. CILINDRO	
ottonato-nichelato brunito	

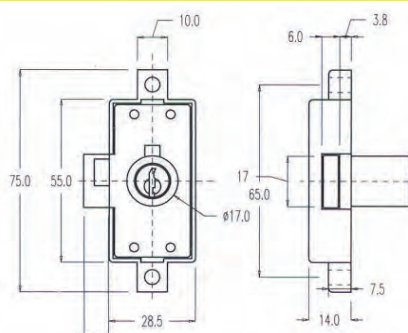

SERRATURA TUTTA METALLO CON CODOLI E CILINDRO

Lock with sleeves en cylinder entirely mode of metal

CG 214C CA

MISURA CATENACCIO	MISURA ENTRATA
mm. 38-48-55	mm. 15-25-33
DISPONIBILE	FINITURA
rotazione 360° rotazione 90°	bronzata-nichelata ottonata-verniciata nera
FINIT. CILINDRO	
ottonato-nichelato brunito	

A richiesta catenaccio a filo

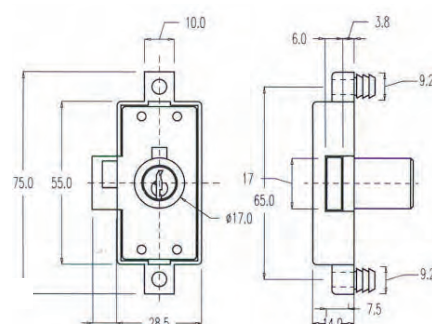

SERRATURA AD ASTE ROTANTI CON POMOLO-CILINDRO

Espagnolette locks with cylinder knob

CG 0241 CA

FUNZIONAMENTO

rotazione 360°
(2 uscita chiave)

APPLICAZIONE

anta

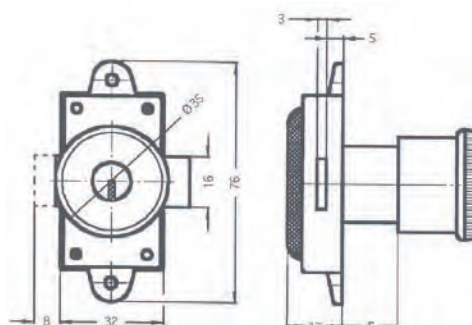

SERRATURA AD ASTE ROTANTI CON POMOLO-CILINDRO

Espagnolette locks with cylinder knob

CG 0240 CA

FUNZIONAMENTO

rotazione 360°
(2 uscita chiave)

APPLICAZIONE

anta

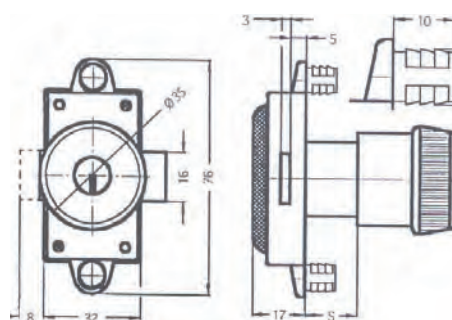

CAVALLOTTI PER ASTA AVVITARE CON BUSSOLA / *Screwed saddle for bar with bush*

CG 605V CA

FINITURA

bronzata-nichelata
ottonata-verniciata nera

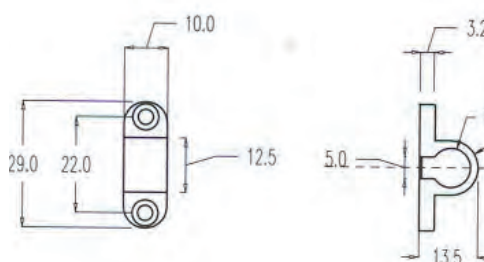

CAVALLOTTO PER ASTA PRESSIONE CON BUSSOLE / *Pressure saddle for bar with bush*

CG 605P CA

FINITURA

bronzata-nichelata
ottonata-verniciata nera

A richiesta catenaccio a filo

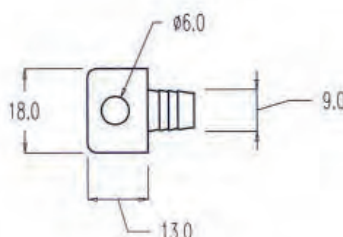

GANCIO AVVITARE / To be screwed hook

CG 604V CA

FINITURA

bronzata-nichelata
ottonata-verniciata
nera

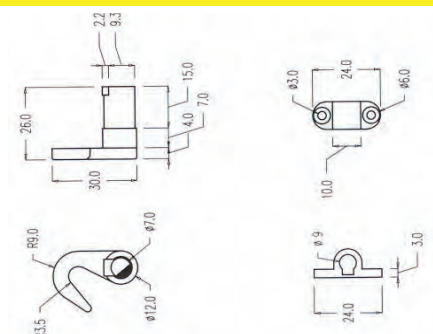

GANCIO COMPLETO SMONTABILE AVVITARE / Screwed detachable complete hook

CG 606V CA

FINITURA

bronzata-nichelata
ottonata-verniciata
nera

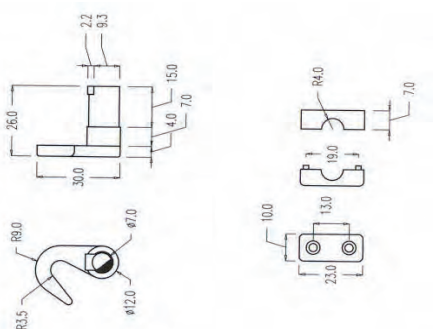

GANCIO COMPLETO SMONTABILE PRESSIONE / Pressure detachable complete hook

CG 606P CA

FINITURA

bronzata-nichelata
ottonata-verniciata nera

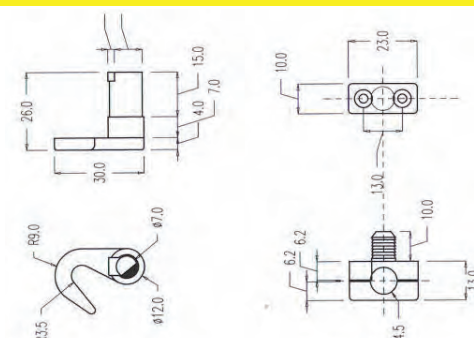

GANCIO PRESSIONE / Pressure hook

CG 604P CA

FINITURA

bronzata-nichelata
ottonata-verniciata nera

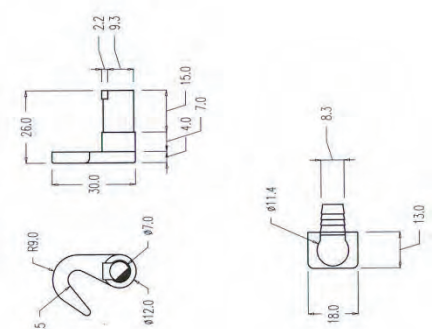

PERNO AUTOFILETTANTE / Pin self threading

CG 601A CA

FINITURA

zincato-bronzato

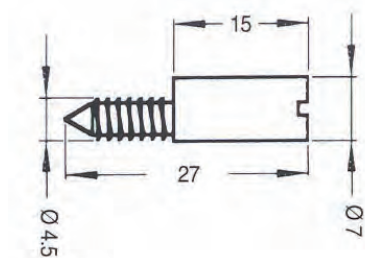

PERNO 6MA / Pin 6 MA

CG 601N CA

FINITURA

zincato-bronzato

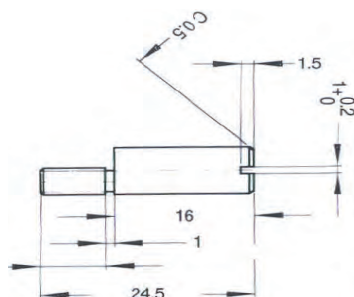

PERNO REGOLABILE / Adjustable pin

CG 0363 CA

FINITURA

zincato
nero

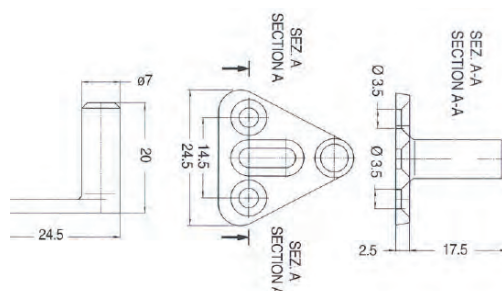

ASTA PER SERRATURE / Lock for bar

CG 1500 PI

FINITURA

grezza-bronzata
nichelata-verniciata nera

MISURA

mm. 900-1000-1100
1200-1300-1400-1500
1600

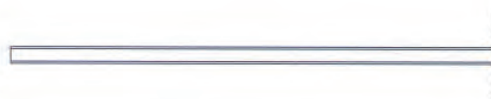
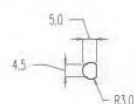

SERRATURA AD ASTE ROTANTI AD INCASTRO / Embedding espagnolette locks

CG 345C CA

FUNZIONAMENTO

rotazione 360°
(2 uscita chiave)

APPLICAZIONE

antina destra-sinistre

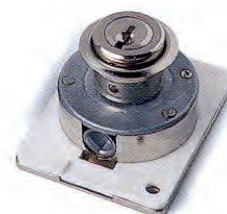
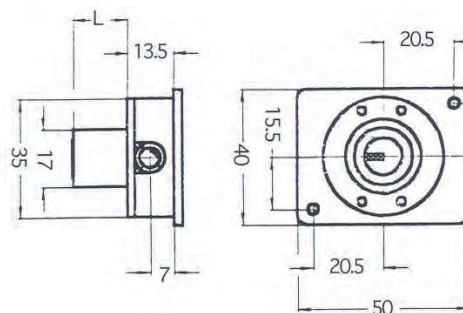

SERRATURA AD ASTE ROTANTI AD INCASTRO / Embedding espagnolette locks

CG 345N CA

FUNZIONAMENTO

rotazione 360°
(2 uscita chiave)

APPLICAZIONE

antina destra-sinistre

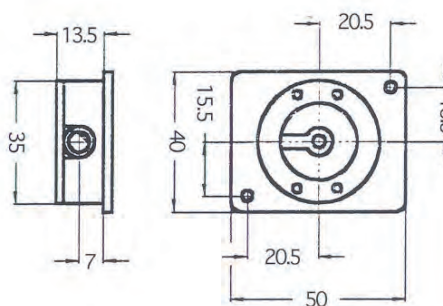

GANCIO A E B / Hook A and B

CG 0613 CA

FINITURA

bronzato, nero, ottonato
nichelato

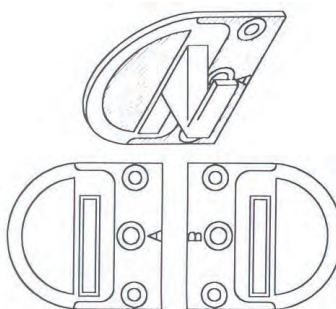

PERNO REGOLABILE / Adjustable pin

CG 0363 CA

FINITURA

zincato, nero

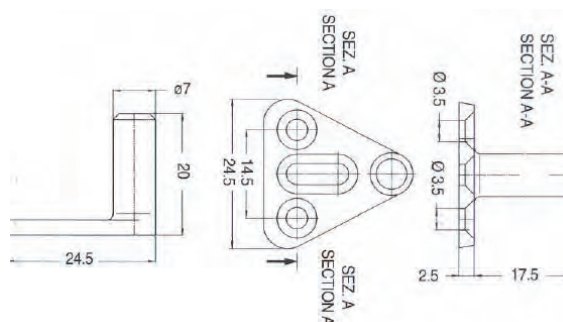

COPRIASTA / Cover

CG 0283 CA

COLORE

nylon bianco, nylon
marrone
nylon nero

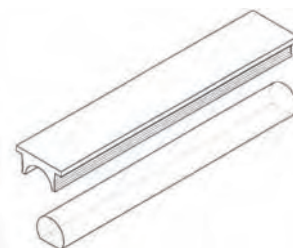
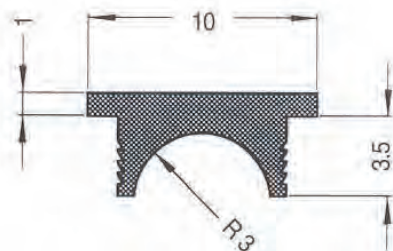

ASTA ROTANTE / Rotating bar

CG 0281 CA

FINITURA

ottonata, nichelata,
bronzata, grezza,
marrone, nero, bianco

APPLICAZIONE

per serrature ed aste
rotanti

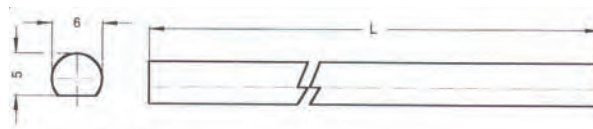

SCHEMA APPLICAZIONE SERRATURE ASTE ROTANTI AD INCASTRO

Application diagram for embedding rotating bar locks

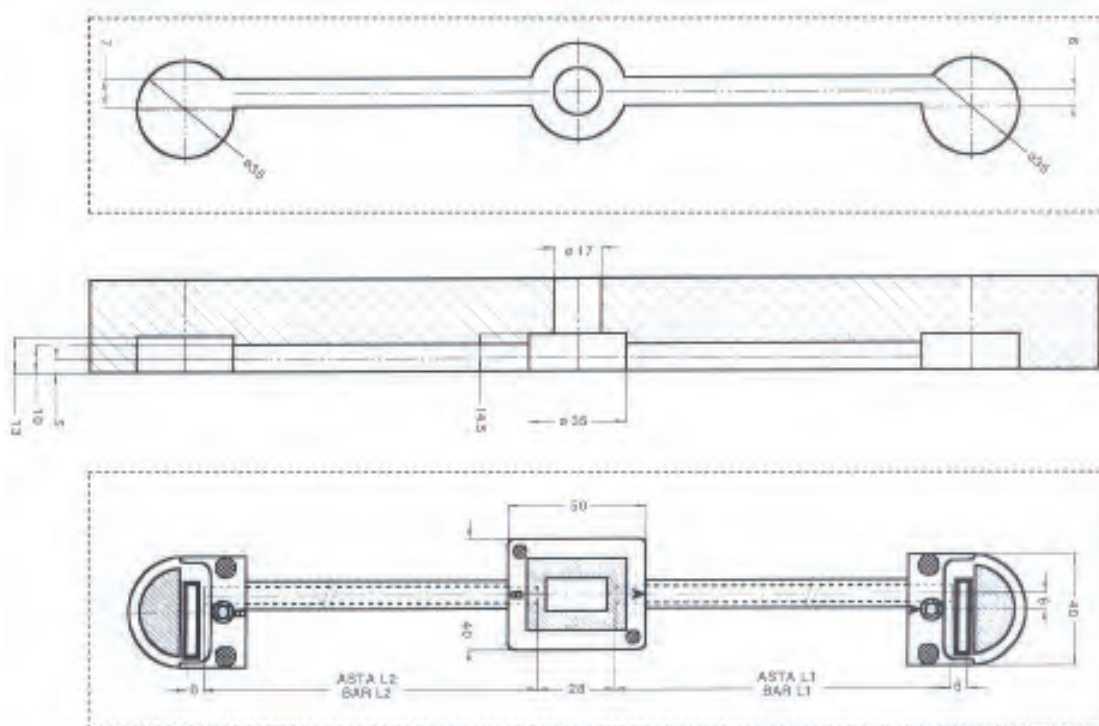

SCHEMA APPLICAZIONE SERRATURE ASTE ROTANTI A SCOMPARSA

Application diagram for hidden rotating bar locks

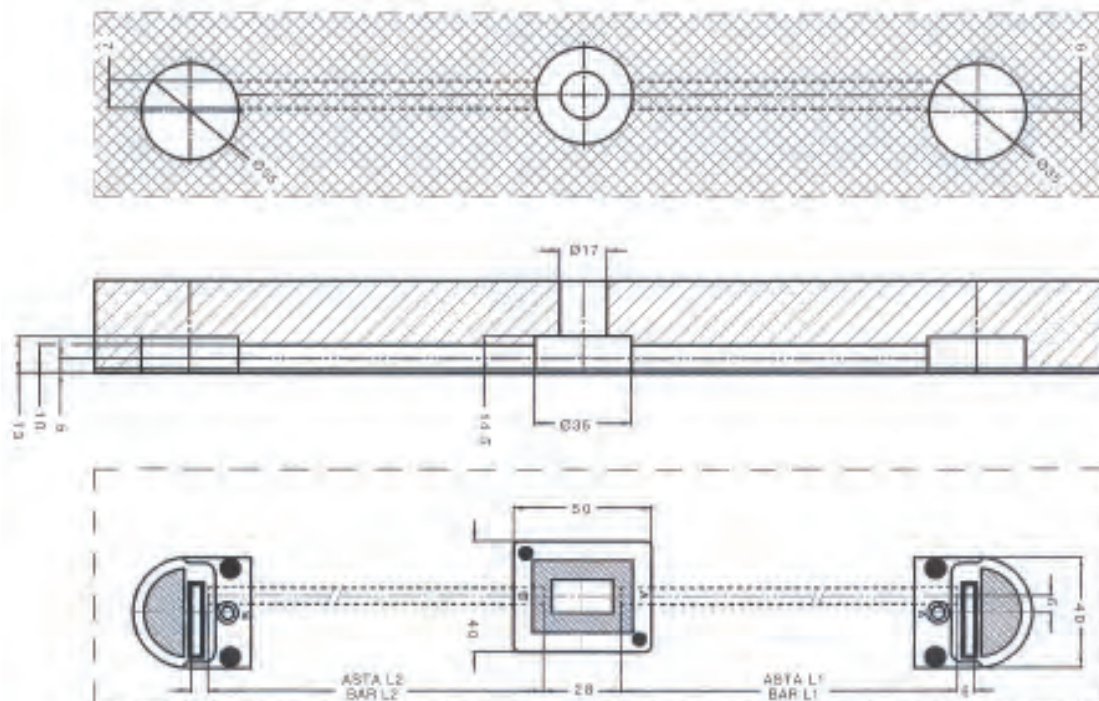

CG 216C1 CA

FUNZIONAMENTO

rotazione 90° dx o sx
(1 uscita chiave)

APPLICAZIONE

anta singola vetro

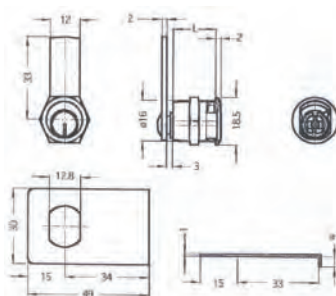

CG 216C3 CA

FUNZIONAMENTO

rotazione 90° dx o sx
(1 uscita chiave)

APPLICAZIONE

anta singola e
doppia vetro

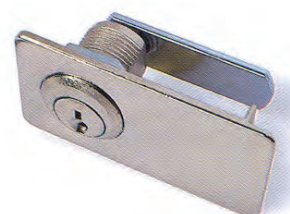
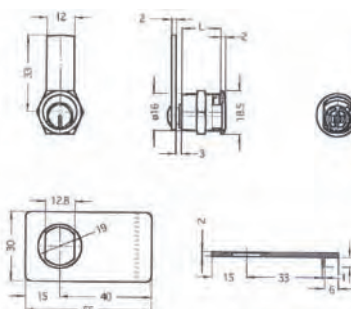

CG 216C1C2 CA

FUNZIONAMENTO

rotazione 90° dx o sx
(1 uscita chiave)

APPLICAZIONE

anta doppia vetro

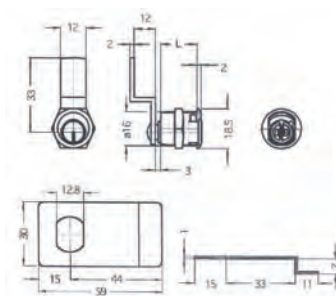

SERRATURA PER VETRO SCORREVOLE / Locks for sliding glass doors

CG 419C CA

FUNZIONAMENTO

rotazione 90° dx
(1 uscita chiave)

APPLICAZIONE

ante a vetro
scorrevoli

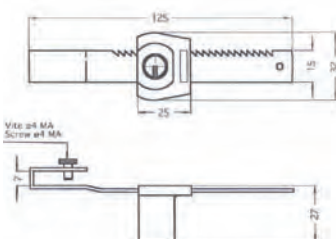

CG 012R CA

FUNZIONAMENTO

rotazione 360°
(2 uscite chiave)

APPLICAZIONE

cassetto, antina
dx o sx

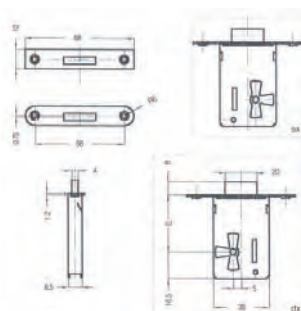

CG 0051 CA

FUNZIONAMENTO

rotazione 45°
(1 uscita chiave)

APPLICAZIONE

antine scorrevoli

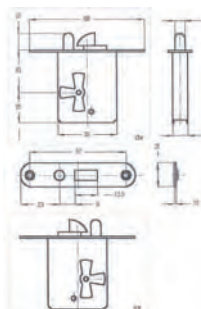

CG 0053 CA

FUNZIONAMENTO

rotazione 360°
(2 uscite chiave)

APPLICAZIONE

cassetto, antina
dx e sx

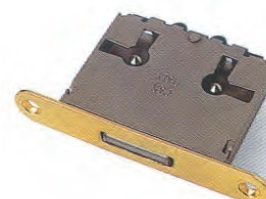
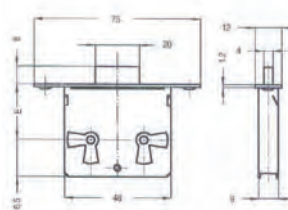

Technical drawings of a mechanical part, showing various views: top, front, side, and cross-sections. Dimensions are provided in millimeters (mm).

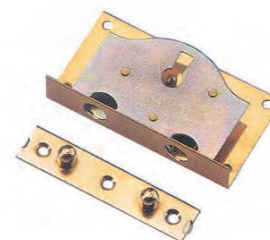
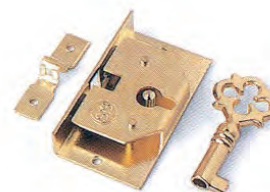

Technical drawing of a decorative plate. The front view shows a rectangular plate with a width of 97 and a height of 103. It features a central rectangular panel with two circular knobs, each with a diameter of 25. The side view shows a thickness of 16 and a mounting flange with a diameter of 45. The plate has a decorative, wavy bottom edge.



CG 8076 CA

FUNZIONAMENTO

rotazione 360°
(2 uscite chiave)

APPLICAZIONE

antina dx-sx,
cassetto

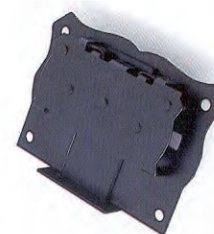
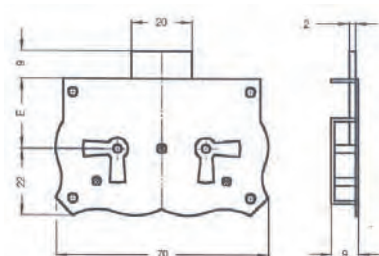

CG 5005 CF

FINITURA

Ferro grezzo
Ferro brunito nero
Ferro ottonato anticato

MISURA ENTRATA

da mm 20 a mm 60

Serratura in stile entrata grande



CG 5010 CF

FINITURA

Ferro grezzo
Ferro brunito nero
Ferro ottonato lucido
Ferro ottonato anticato
Ferro arrugginito

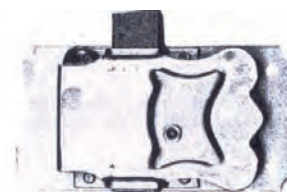

CG 5011 CF

FINITURA

Ferro grezzo
Ferro brunito nero
Ferro ottonato lucido
Ferro ottonato anticato
Ferro arrugginito

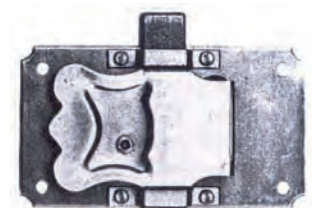

CG 5012 CF

FINITURA

Ferro grezzo
Ferro brunito nero
Ferro ottonato lucido
Ferro ottonato anticato
Ferro arrugginito



CG 5013 CF

FINITURA

Ferro grezzo
Ferro brunito nero
Ferro ottonato lucido
Ferro ottonato anticato
Ferro arrugginito

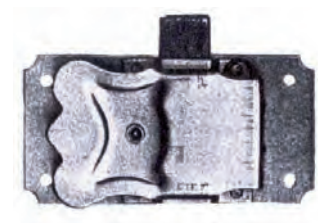

CG 5014 CF

FINITURA

Ferro grezzo
Ferro brunito nero
Ferro ottonato lucido
Ferro ottonato anticato
Ferro arrugginito

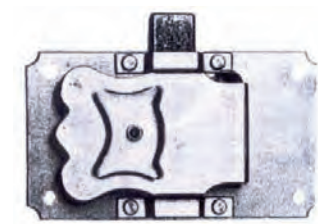

CG 5023 CF

FINITURA

Ferro grezzo
Ferro brunito nero
Ferro ottonato lucido
Ferro ottonato anticato
Ferro arrugginito

MISURA ENTRATA

da mm 30 a mm 70



CG 5022 CF

FINITURA

Ferro grezzo
Ferro brunito nero
Ferro ottonato lucido
Ferro ottonato anticato
Ferro arrugginito

MISURA ENTRATA

da mm 30 a mm 70



CG 5015 CF

FINITURA

Ferro grezzo
Ferro brunito nero
Ferro ottonato lucido
Ferro ottonato anticato
Ferro arrugginito

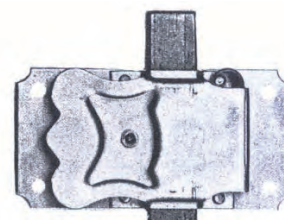

CG 5016 CF

FINITURA

Ferro grezzo
Ferro brunito nero
Ferro ottonato lucido
Ferro ottonato anticato
Ferro arrugginito



CG 5018 CF

FINITURA

Ferro grezzo
Ferro brunito nero
Ferro ottonato lucido
Ferro ottonato anticato
Ferro arrugginito

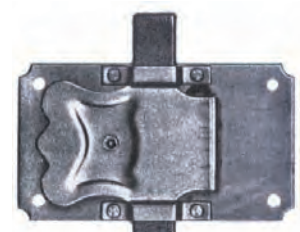

CG 5020 CF

FINITURA

Ferro grezzo
Ferro brunito nero
Ferro ottonato lucido
Ferro ottonato anticato
Ferro arrugginito



CG 5025 CF

FINITURA

Ferro arrugginito

MISURA ENTRATA

da mm 60 a mm 90



CG 5070 CF

FINITURA

Ferro grezzo
Ferro brunito nero
Ferro ottonato lucido
Ferro ottonato anticato

MISURA ENTRATA

da mm 20 a mm 50

Serratura per mobili in stile ad aste rotanti



CG 5080 CF

FINITURA

Ferro grezzo
Ferro brunito nero
Ferro ottonato lucido
Ferro ottonato anticato

MISURA ENTRATA

da mm 20 a mm 50

Serratura per mobili in stile ad aste rotanti
modello economico



CG 1070 CF

FINITURA	MISURA
Ferro grezzo	cm. 90 100 110 120
Ferro tropicalizzato	130 140 150 160

Aste esagonali per dette serrature Per ordini superiori a 200 pz. le aste possono essere fornite su misura



ACCESSORI / Accessories

Art.	TIPO
CG 5071 CF	Rullino
CG 5072 CF	Cavallotto
CG 5073 CF	Riscontro tipo A
CG 5074 CF	Riscontro tipo B
CG 5075 CF	Riscontro tipo C
CG 5076 CF	Riscontro tipo D
CG 5077 CF	Riscontro tipo E

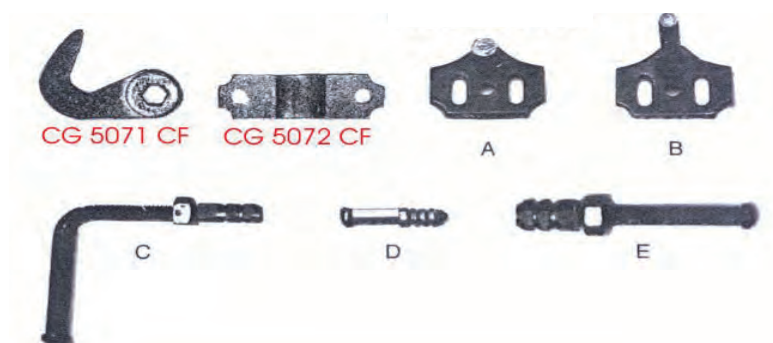

CG 0333 CA

FUNZIONAMENTO

rotazione 360°
(2 uscite chiave)

APPLICAZIONE

antina dx - sx

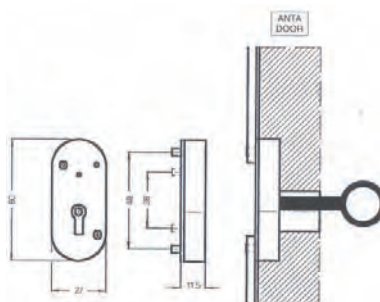

SERRATURA A STRINGA CON CILINDRO / *Pasquil locks with cylinder*

CG 333C CA

FUNZIONAMENTO

rotazione 360°
(2 uscite chiave)

APPLICAZIONE

antina dx - sx

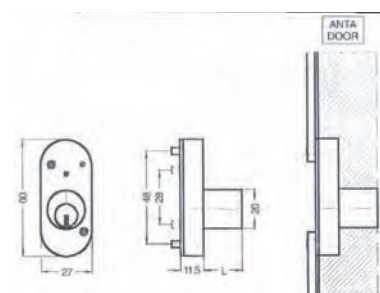

SERRATURA A STRINGA CON CILINDRO / *Pasquil locks with cylinder*

CG 147C CA

FUNZIONAMENTO

rotazione 360°
(2 uscite chiave)

APPLICAZIONE

antina dx - sx

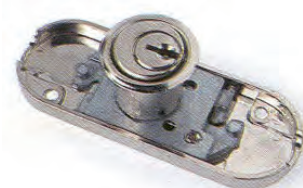
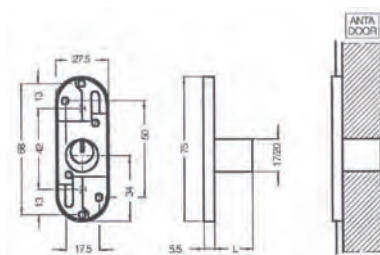

CG 0111 CA

FUNZIONAMENTO

rotazione 360°
(2 uscite chiave)

APPLICAZIONE

antina dx

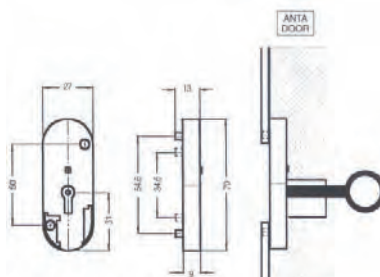

CG 0145 CA

FUNZIONAMENTO

rotazione 360 °
(2 uscite chiave)

APPLICAZIONE

antina dx - sx

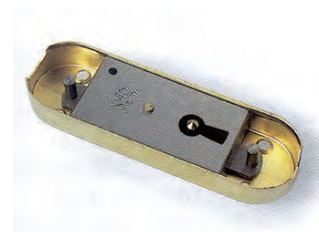
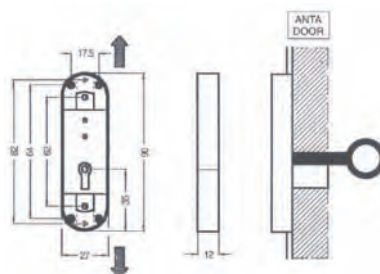

MEZZALUNA / *Plate*

CG 0102 CA

FINITURA

ferro ottonata,
nichel



CAVALLOTTO / *Saddle*

CG 0103 CA

FINITURA

ottonata, nichel,
ferro

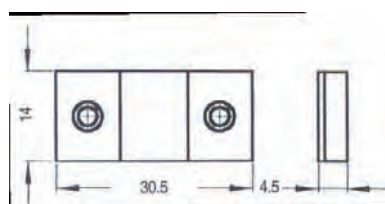

PLACCA COPRISTRINGA / *Covering plate*

CG 2080 PI

FINITURA

plastica marrone-bianca

MISURA

mm. 90x34
mm. 134x36



PLACCA COPRISTRINGA / *Covering plate*

CG 2081 PI

FINITURA

ferro ottonato

MISURA

mm. 90x34
mm. 122x36



POZZETTO / *Well*

CG 0090 CA

FINITURA

ottone

MISURA

Ø mm. 16-19

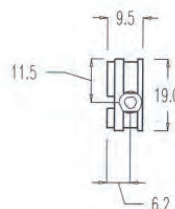
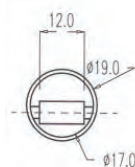

POZZETTO / *Well*

CG 2021 PI

FINITURA

ottone

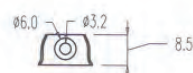
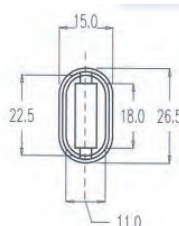

ASTA / *Bar*

CG 1600 PI

FINITURA

grezza-zincata

MISURA

mm. 600-850-900-1000-1100
1200-1300-1400-1500-1600



ASTA / Bar

CG 1610 PI

FINITURA	MISURA
grezza-zincata	mm. 600-850-900-1000-1100 1200-1300-1400-1500-1600

